

FLSCALE

User Guide



driveTM



CAUTION: Do no attempt to use this equipment without first understanding the contents of this manual.

INTRODUCTION

Before using this equipment, and to ensure safe operation of your DRIVE DeVilbiss FLSCALE weight scale, carefully read this entire manual.

Should any questions arise from the reviewing this manual, contact your local authorized representative. Be sure that the contents of this manual are completely understood prior to using the weight scale assembly.

OVERVIEW

The Drive FLSCALE weight scale assembly is ONLY designed for use with the DRIVE Levantar (FLNP500, FLP500) and Gravis Floor Lifts (FLNP600, FLP600). Do not attempt to retro fit the scale to other floor lifts.

Completely self-contained the DRIVE DeVilbiss FLSCALE combines the latest microprocessor and load cell technology to provide accurate and repeatable weight data with a calibrated accuracy of 0.1 kg/ 0.2 lbs. One button AutoZero Electronics makes patient weighting quick and easy.

SPECIFICATIONS

Weight Range:	660lbs / 300kg
Display Resolution:	0.2 lb / 0.1 kg
Accuracy:	0.2 lb / 0.1 kg
Display Type:	0.7 / 17.8 mm numerical LCD
Size:	3.2 in x 1.8 in x 5.5 in (81.3mm x 45.7 mm x 139.7 mm)
Unit Weight:	1.37 lbs / 620 g
Power Supply:	3-AA batteries
Battery Life:	Approximately 150 hours

BATTERY REPLACEMENT

An indicator will appear on the display when the batteries need replacing. To remove the batteries, remove the screws which fasten the access door on the back of the scale with Phillips head screwdriver.

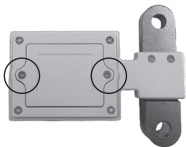

Warning: the load cell contains no user serviceable components and should be service by qualified personnel only. Any unauthorized tampering will void the warranty.

COMPONENTS

Make sure that the following components are included with the DRIVE FLSCALE weight scale assembly:

- DRIVE FLSCALE load cell scale
- Washer x2
- Pin x2
- (3) AA batteries
- Key Ring x2
- Owner's Manual

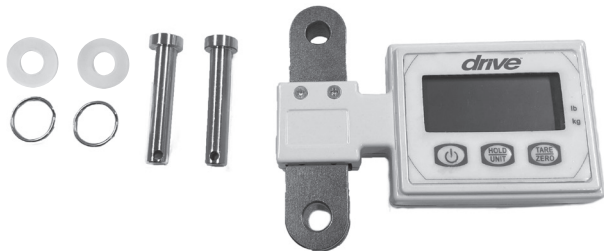

DRIVE #FLSCALE SCALE INSTALLATION



Bolt and nut
provided with lift

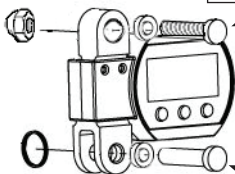

Pin and key ring
provided with scale

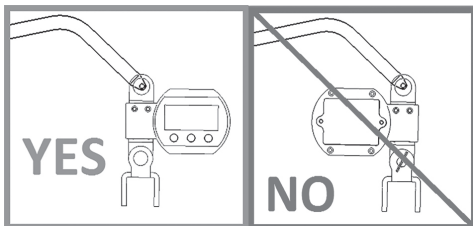
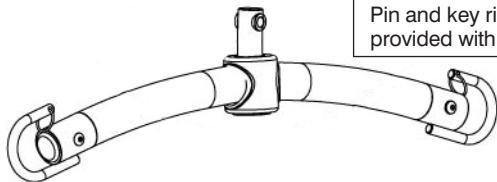

SCALE SETTING

Power ON/OFF

Power ON: Press  for 1 second. Scale will boot up, run battery test and initialize.

Screen shows detection message while scale detects load and auto-zeros.

Power OFF: Press  for 1 second to power off scale. Display shows power-off message.

Hold Display

Press  to lock the display. "HOLD" shows on display and display is locked.

Press  to resume display. "HOLD" disappears and the display resumes refreshing.

Unit of Measurement

Press  for 1 second to switch measuring units between lbs, kg.

Zero Scale

Press  for 1 second to zero scale. "ZERO" shows on display and weight turns to zero.

Auto-Off

Press  and  simultaneously for 1 second to enter setting mode.

Press  to enter Auto-Off option; and press  to change Auto-Off option.

Auto-Off can be set to 0,5,15,30 or 60 min.

Press  to exit setting mode.





SCALE SETTING (CONTINUED)

Backlight

Press  and  simultaneously for 1 second to enter setting mode.



Press  to enter backlight option and press  to change backlight option.





Backlight can be set to permanently off. Permanently on, or 5, 15, 20, 30 and 60 sec.

When backlight is set to 5, 15, 30 or 60 seconds, then scale turns off backlight in corresponding seconds after if is stable.

Press  to exit setting mode.



OPERATION

1. Attach the scale assembly as described in the installation instructions.
2. Attach the empty sling or stretcher to the carry hook.
3. Press  to set the system to zero.
4. Press  for 1 second to switch measuring units between lbs, kg.
5. Unhook the sling or stretcher.
6. Position patient in the sling or stretcher – refer to lift and sling documentation for positioning and lifting instructions.
7. Reattach the sling or stretcher with patient to the cradle bar hooks.
8. Carefully lift the patient with the lift system.
9. When motion has stabilized, display will show weight data-Do not touch the patient or sling/stretcher while stabilizing.
10. Carefully lower the patient when weighting process is complete.

WARRANTY

This warranty does not affect or in any way limit your statutory rights.

Drive DeVilbiss guarantee this FLSCALE floor scale for 1 year from date of installation or 18 months from date of manufacturing, whichever is shorter, by virtue of defects in material or workmanship.

This guarantee does not apply to failure attributed to normal wear and tear, damage by natural forces, user neglect or misuse or deliberate destruction, or batteries more than 90 days after original purchase.

This guarantee shall be void if the equipment is not serviced by DRIVE DeVilbiss Medical or its authorized service agents in accordance with the manufacturer's recommendations or if any unauthorized person carries out or works on the equipment.

The liability of Drive DeVilbiss under the terms of this agreement shall be limited to the replacement of the defective parts and in no event shall Drive DeVilbiss incur liability for any consequential or unforeseen losses.



CAUTION: This device is not intended for use during patient transport and should be removed in such case.

driveTM

99 Seaview Boulevard
Port Washington, NY 11050

www.drivemedical.com
VerA.06.19