

ZOOME AUTO-FLEX

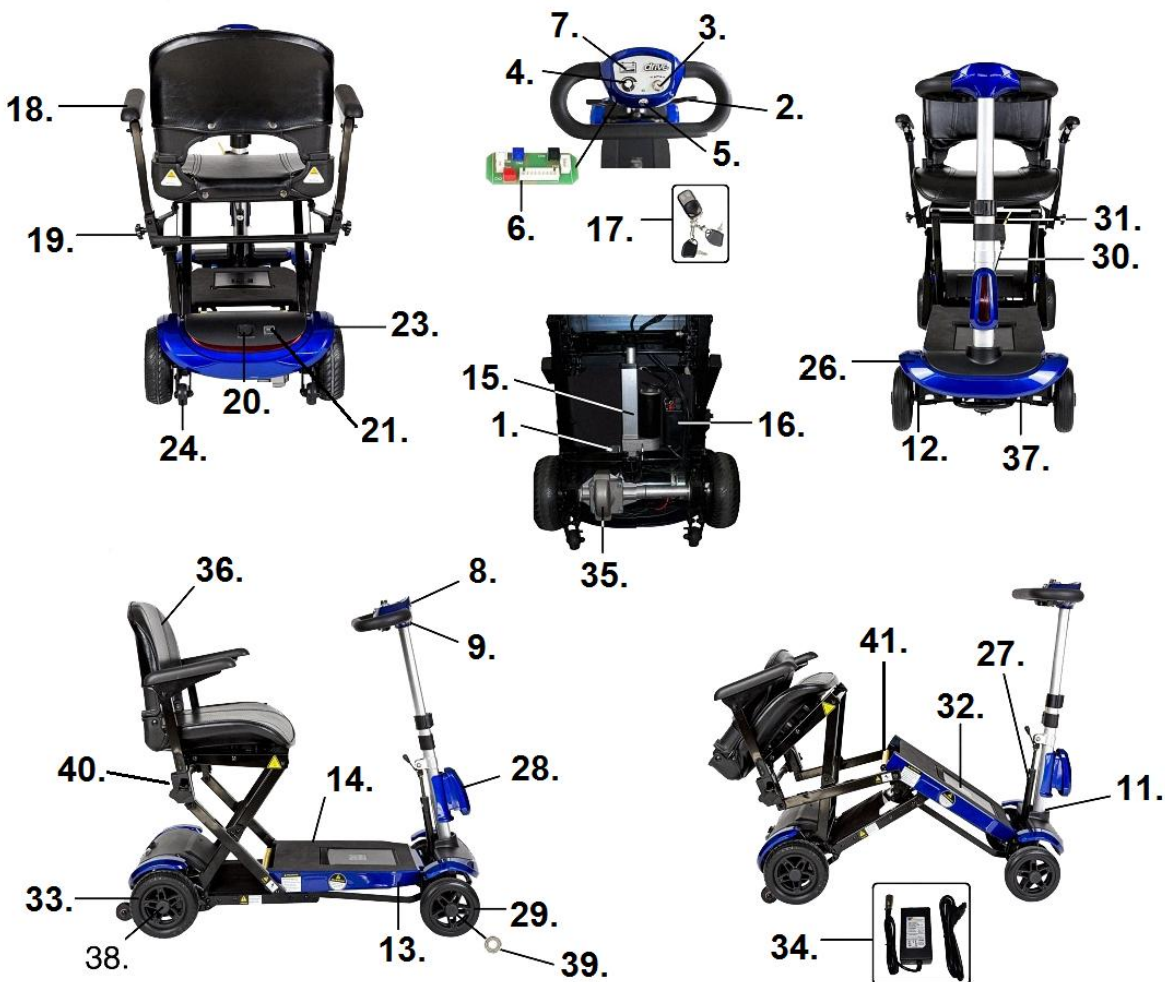

- | | |
|--|---|
| <p>1. Controller- FLEX-29</p> <p>2. Throttle Pot- FLEX-AUTO-01 Throttle Pot Assembly- FLEX-AUTO-02 Throttle Lever- FLEX-AUTO-03</p> <p>3. On-Off Switch- FLEX-AUTO-05</p> <p>4. Speed Pot- FLEX-AUTO-06</p> <p>5. Horn Button- FLEX-AUTO-07 Horn- FLEX-AUTO-04</p> <p>6. Junction Board- FLEX-AUTO-08</p> <p>7. Battery Gauge- FLEX-AUTO-09</p> <p>8. Upper Console Blue- FLEX-AUTO-10 Upper Console Red- FLEX-AUTO-10R</p> <p>9. Lower Console Blue- FLEX-AUTO-11 Lower Console Red- FLEX-AUTO-11R</p> <p>10. Quick Release Clamp- FLEX-AUTO-12</p> <p>11. Handle Connector- FLEX-AUTO-13</p> <p>12. Steering Knuckle, Left- FLEX-AUTO-14 Steering Knuckle, Right- FLEX-AUTO-15</p> <p>13. Footboard Blue- FLEX-AUTO-16 Floorboard Red- FLEX-AUTO-16R</p> <p>14. Floor Mat- FLEX-AUTO-17</p> <p>15. Folding Actuator Assembly- FLEX-AUTO-18 Folding Actuator Assembly- FLEX-AUTO-51 *</p> <p>16. Wireless Receiver- FLEX-AUTO-19 Wireless Receiver- FLEX-AUTO-50 *</p> <p>17. Key- FLEX-AUTO-20 Wireless Remote Key- FLEX-AUTO-21</p> <p>18. Armrest Assembly, Left- FLEX-AUTO-23 Armrest Assembly, Right- FLEX-AUTO-24 Armpad- FLEX-37</p> <p>19. Armrest Knob- FLEX-AUTO-25</p> <p>20. Charger Port- FLEX-AUTO-26</p> <p>21. Actuator Switch- FLEX-AUTO-27</p> <p>22. Reverse Horn- FLEX-AUTO-28</p> <p>23. Rear Shroud Blue- FLEX-AUTO-29 Rear Shroud Red- FLEX-AUTO-29R Rear Shroud Decoration Blue- FLEX-AUTO-30 Rear Shroud Decoration Red- FLEX-AUTO-30R</p> | <p>24. Anti Tip Wheel- FLEX-AUTO-31</p> <p>25. Main Harness- FLEX-AUTO-45</p> <p>26. Front Cover- FLEX-12</p> <p>27. Gas Spring Assembly- FLEX-AUTO-34</p> <p>28. Front Reflector Assembly Blue- FLEX-AUTO-39 Front Reflector Assembly Red- FLEX-AUTO-39R</p> <p>29. Front Wheel- FLEX-07</p> <p>30. Release Cable- FLEX-AUTO-46</p> <p>31. Release Lever- FLEX-21</p> <p>32. Battery Pack- FLEX-22 ** Battery Case Only- FLEX-16 ** Battery Pack- FLEX AUTO-47 *** Battery Case Only- FLEX-AUTO-48 *** Battery Contacts (4 ea)- FLEX-31</p> <p>33. Rear Wheel- FLEX-25</p> <p>34. Battery Charger- FLEX-27</p> <p>35. Motor/Brake/Transaxle Assembly- FLEX-AUTO-44 Transaxle- FLEX-51 Motor- FLEX-52 Brake- FLEX-AUTO-43</p> <p>36. Seat Complete- FLEX-AUTO-37 Back Upholstery- FLEX-AUTO-36 Seat Upholstery- FLEX-AUTO-35</p> <p>37. Tie Rod Complete- FLEX-13</p> <p>38. Hub Cap- FLEX-30</p> <p>39. Wheel/Stem Bearing- FLEX-11</p> <p>40. Armrest Receiver, Left- FLEX-AUTO-32 Armrest Receiver, Right- FLEX-AUTO-33</p> <p>41. Folding Latch Assembly Yellow- FLEX-AUTO-38 Folding Latch Assembly Red- FLEX-AUTO-49 *</p> <p>Not Shown- External Charging Docking Station- FLEX-50 Basket Only- FLEX-AUTO-40 Basket mount- FLEX-AUTO-41 Cup Holder- FLEX-AUTO-42</p> |
|--|---|

* Serial # (21)24S1803000001 & higher

** Serial # lower than (21)24S1712000001

*** Serial # (21)24S1712000001 & higher